

ASSEMBLY INSTRUCTIONS



**Office
Boffins**

A-5 PCS



B-16 PCS



M6*20mm

C-2 PCS



M8*60mm

D-2 PCS



E-1 PC



F-2 PCS



G-6 PCS



Ø8×22×1.5mm

H-4 PCS



Ø8×38×1.5mm

I-1 PC

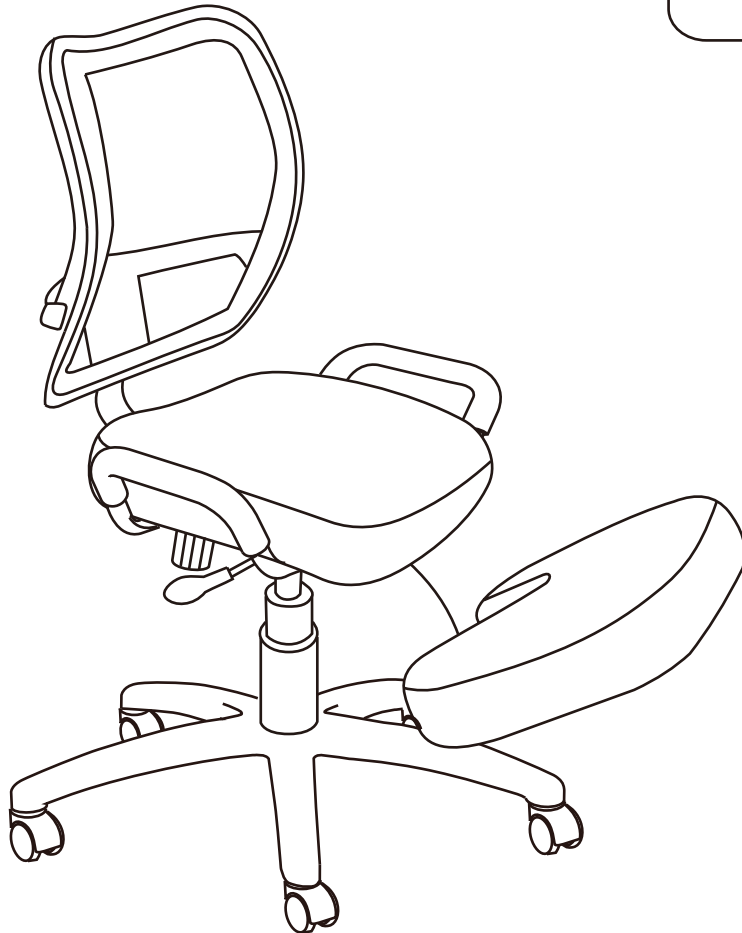

PROKN001

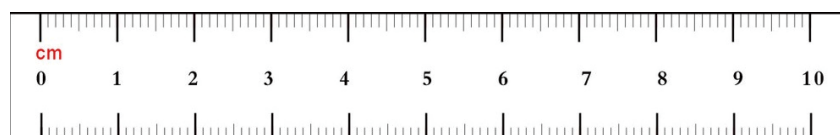

Do not tighten bolts fully until you have completed assembly.

DO NOT USE A POWER DRILL TO TIGHTEN THE SCREWS.

TIGHTEN BY HAND WITH THE ALLEN KEY PROVIDED.

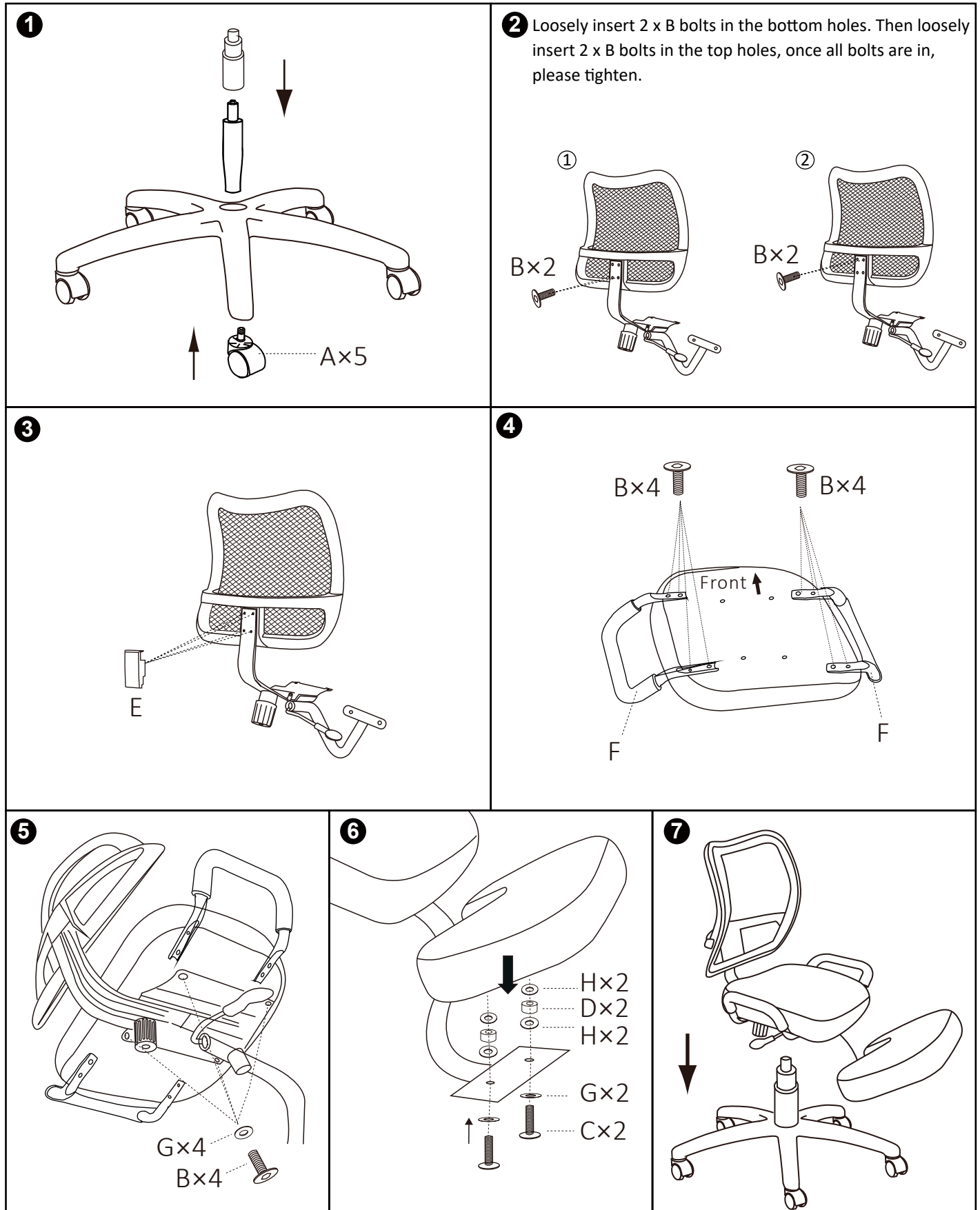

WARNING

- DO NOT STAND ON THIS CHAIR.
- DO NOT USE THIS CHAIR AS A STEP LADDER.
- USE THIS PRODUCT FOR SEATING ONE PERSON AT A TIME ONLY.
- DO NOT USE THIS CHAIR UNLESS ALL BOLTS, SCREWS AND KNOBS ARE FIRMLY SECURED.
- AT LEAST EVERY 6 MONTHS, CHECK ALL BOLTS, SCREWS AND KNOBS TO BE SURE THEY ARE TIGHT.
- IF PARTS ARE MISSING, BROKEN, DAMAGED OR WORN, STOP USING THIS PRODUCT UNTIL REPAIRS ARE MADE USING FACTORY AUTHORISED PARTS.
- FAILURE TO FOLLOW THESE WARNINGS COULD RESULT IN SERIOUS INJURY.

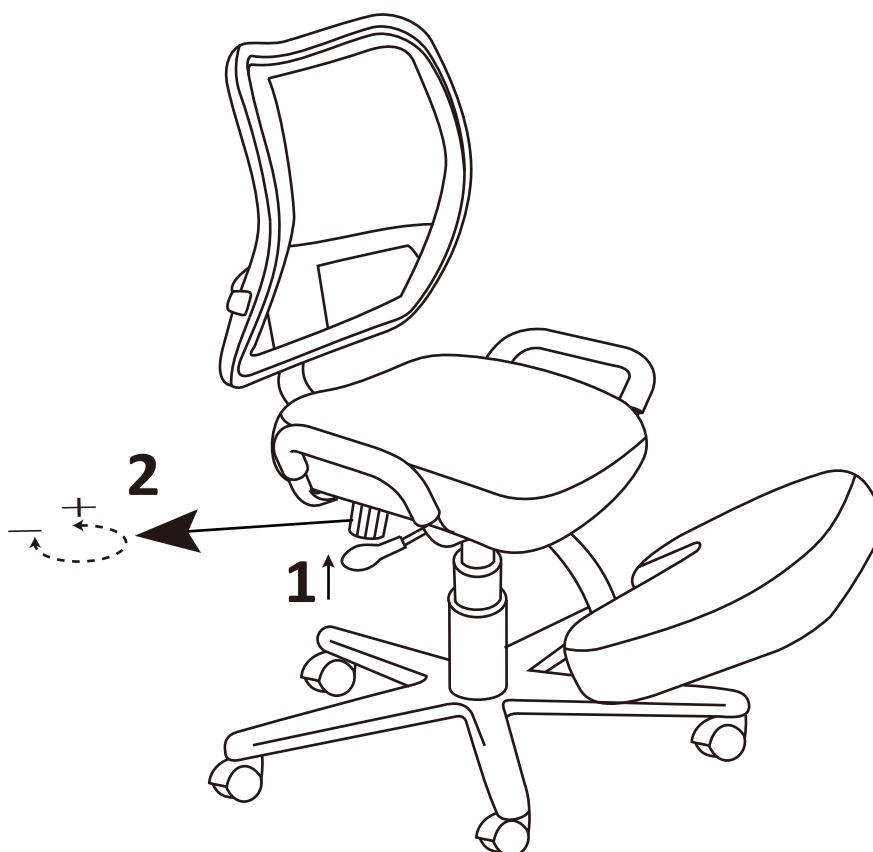

1

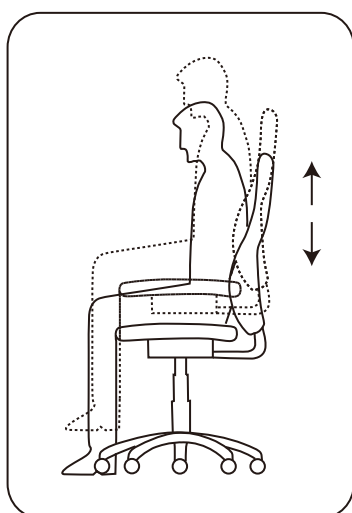

2

