

ASSEMBLY INSTRUCTIONS



Office Boffins



PEXECL001 PEXECF001

A-1PC

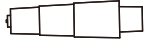

B-5PCS



C-4PCS
(22mm)



PRE-INSERTED

D-4PCS
(45mm)

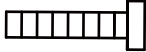

E-4PCS
(30mm)



PRE-INSERTED

F-4PCS



G-2PCS



PLEASE NOTE:

The screws "C" and "E" are pre-inserted into their correct holes to prevent them from being lost in transit. Please remove them before assembly using the allen key provided.

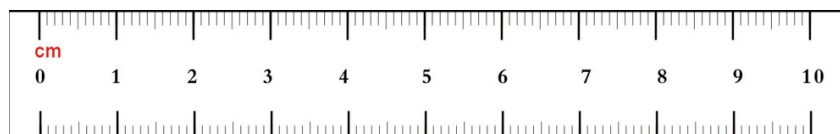

**Do not tighten bolts fully until you have completed assembly.
DO NOT USE A POWER DRILL TO TIGHTEN THE SCREWS.
TIGHTEN BY HAND WITH THE ALLEN KEY PROVIDED.**

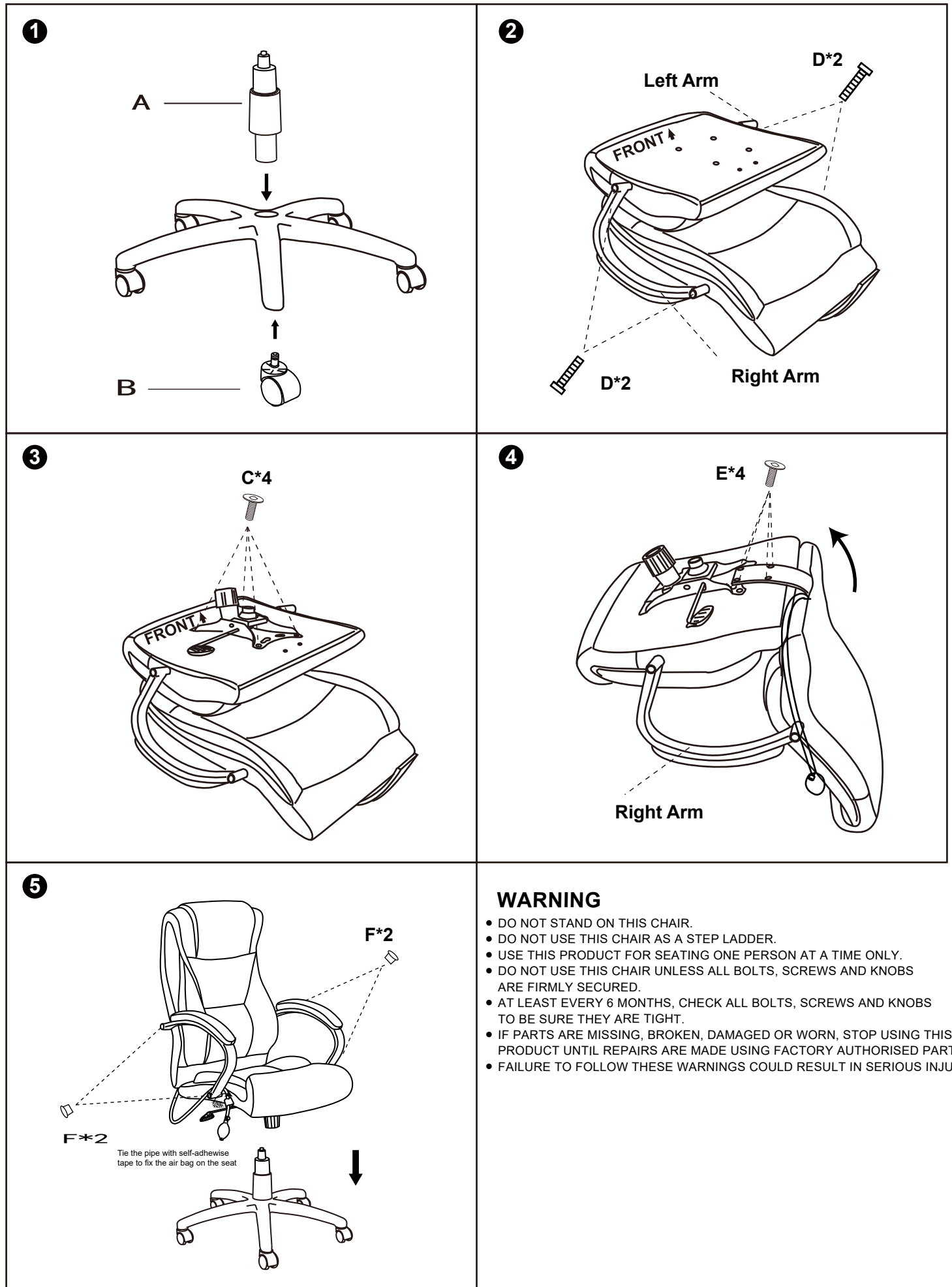

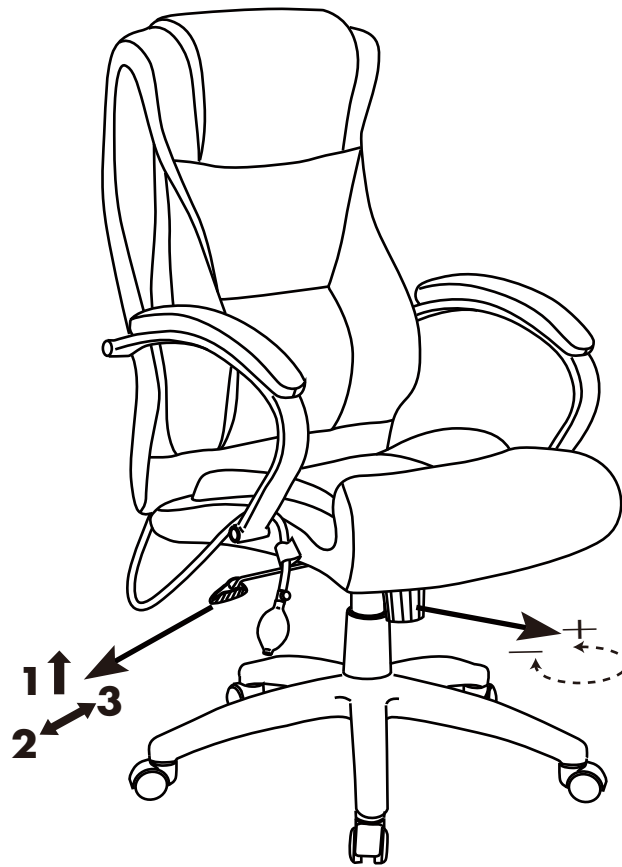

1

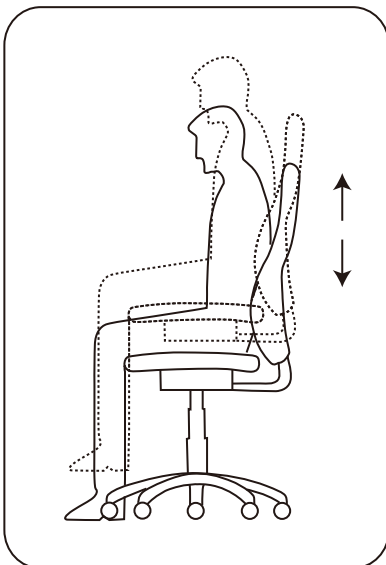

2

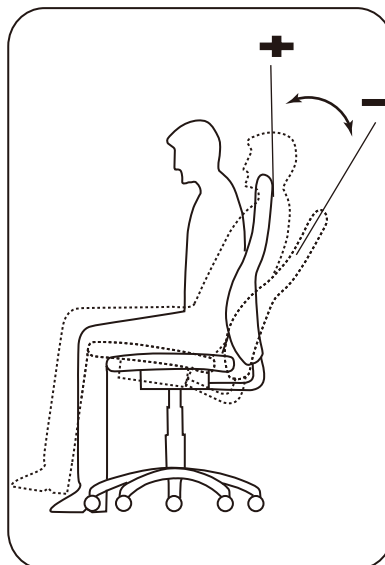

3

