

ASSEMBLY INSTRUCTIONS



Office Boffins



A-5 PCS



B-1 PC



C-1 PC



D-1 PC

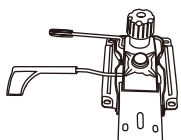

E-2 PCS

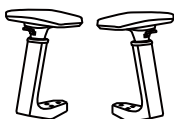

F-1 PC



G-10 PCS
M6×40mm



H-4 PCS
M6×18×1mm



I-7 PCS
M8



J-3 PCS
M8×22mm



K-3 PCS
M8×22×1.5mm



L-6 PCS
M6×15×1mm



M-1 PC



STYM001

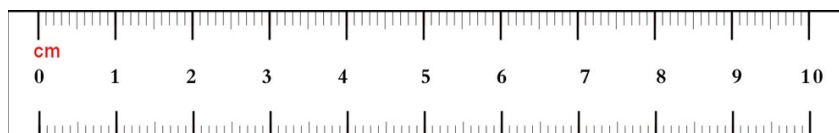

**Do not tighten bolts fully until you have completed assembly.
DO NOT USE A POWER DRILL TO TIGHTEN THE SCREWS.
TIGHTEN BY HAND WITH THE ALLEN KEY PROVIDED.**

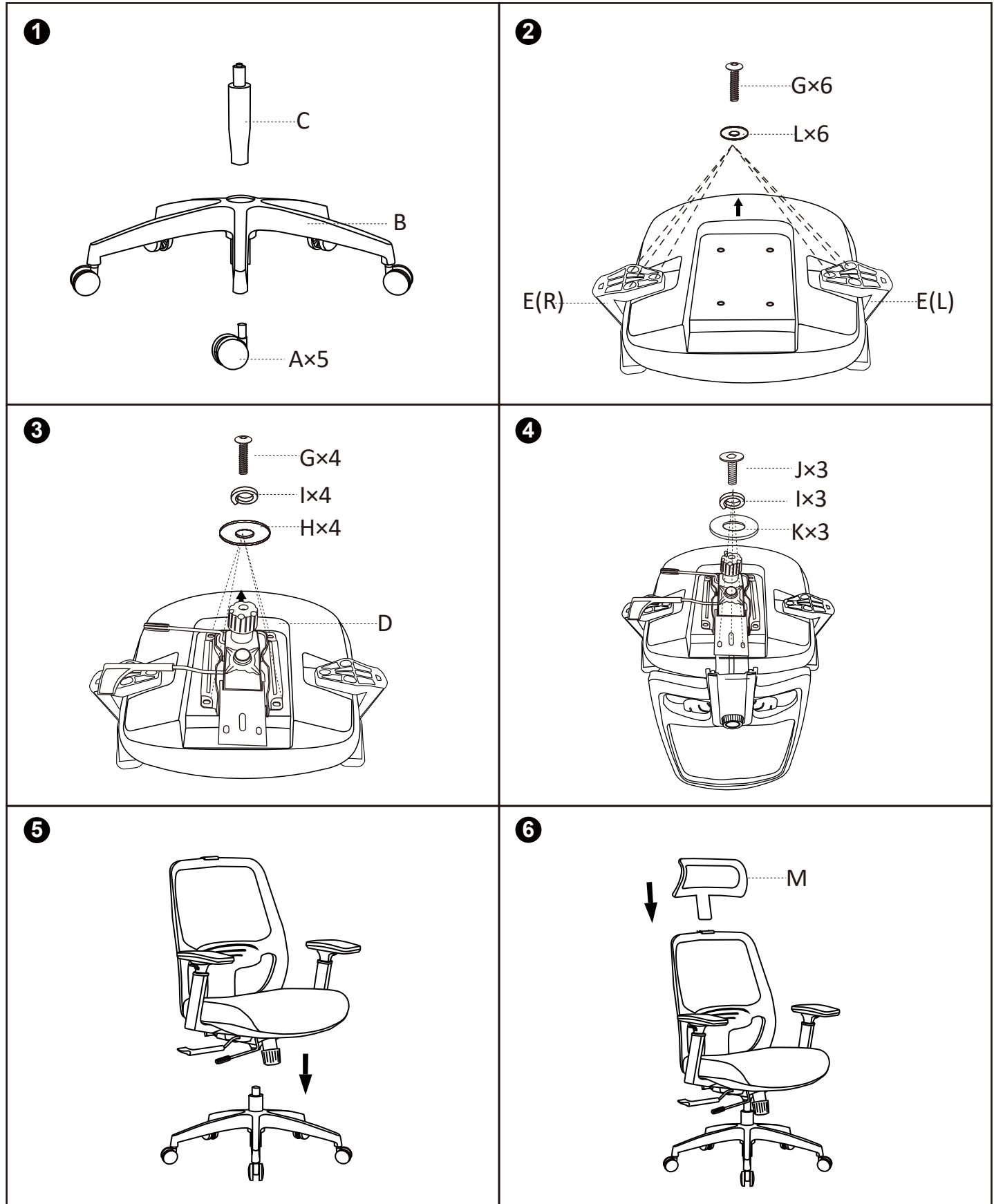

WARNING

- DO NOT STAND ON THIS CHAIR. DO NOT USE THIS CHAIR AS A STEP LADDER
- USE THIS PRODUCT ONLY FOR SEATING ONE PERSON AT A TIME
- DO NOT USE THIS CHAIR UNLESS ALL BOLTS, SCREWS AND KNOBS ARE FIRMLY SECURED
- AT LEAST EVERY 4 MONTHS, CHECK ALL BOLTS, SCREWS AND KNOBS TO BE SURE THEY ARE TIGHT
- IF PARTS ARE MISSING, BROKEN, DAMAGED OR WORN, STOP USE OF THIS PRODUCT UNTIL REPAIRS ARE MADE, USING FACTORY AUTHORISED PARTS
- FAILURE TO FOLLOW THESE WARNINGS COULD RESULT IN SERIOUS INJURY

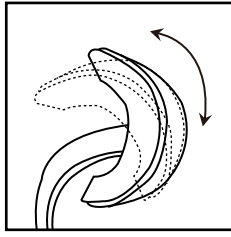
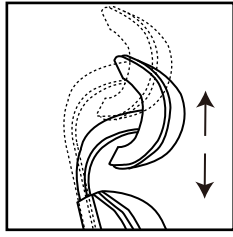

1

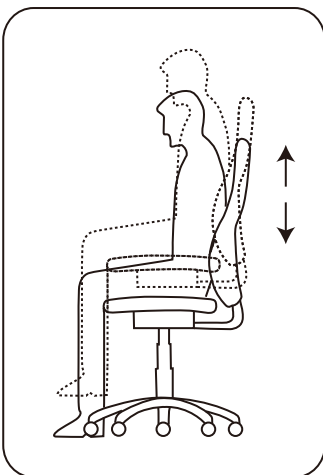

2

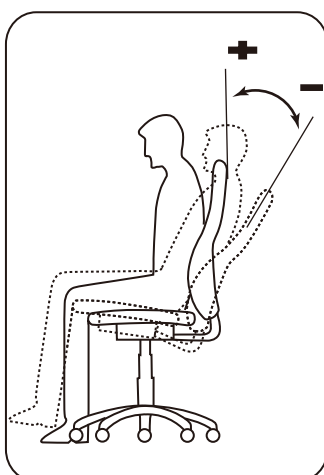

3

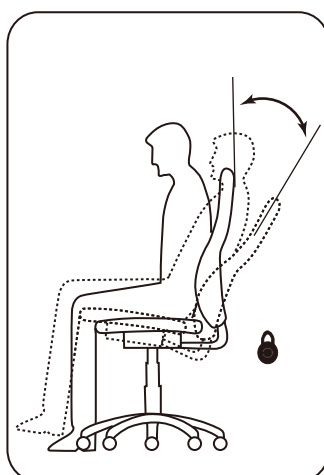

4

