

ASSEMBLY INSTRUCTIONS

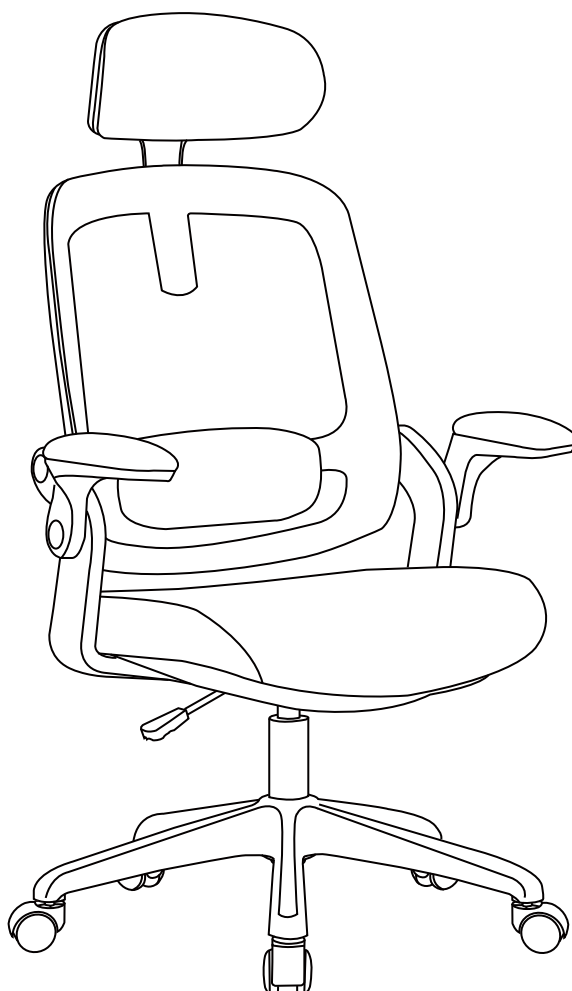

Office Boffins



BASE001

A-5 PCS



B-1 PC



C-1 PC



D-1 PC



E-2 PCS

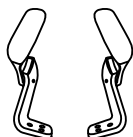

F-1 PC



G-1 PC

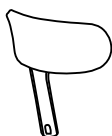

H-1 PC
M6×25 mm



I-2 PCS
M6×16 mm



J-6 PCS
M6×40 mm



K-6 PCS
M6×15 mm



L-1 PC

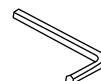

M-1 PC



N-1 PC

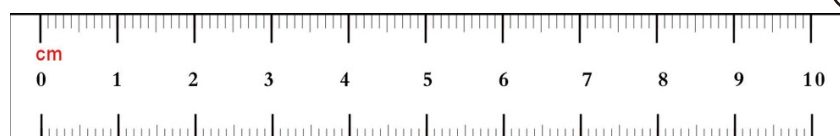

**Do not tighten bolts fully until you have completed assembly.
DO NOT USE A POWER DRILL TO TIGHTEN THE SCREWS.
TIGHTEN BY HAND WITH THE ALLEN KEY PROVIDED.**

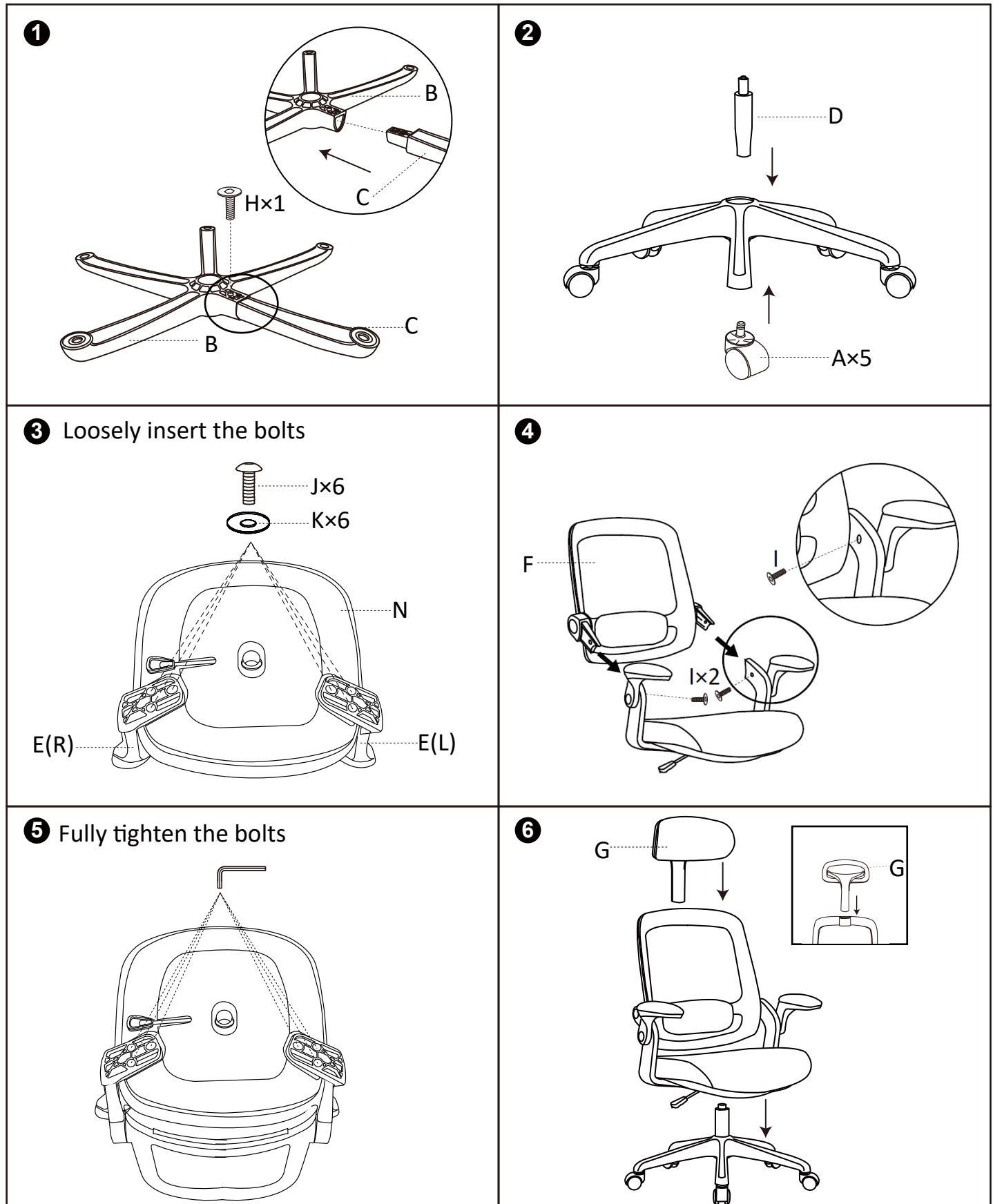

WARNING

- DO NOT STAND ON THIS CHAIR. DO NOT USE THIS CHAIR AS A STEP LADDER
- USE THIS PRODUCT ONLY FOR SEATING ONE PERSON AT A TIME
- DO NOT USE THIS CHAIR UNLESS ALL BOLTS, SCREWS AND KNOBS ARE FIRMLY SECURED
- AT LEAST EVERY 4 MONTHS, CHECK ALL BOLTS, SCREWS AND KNOBS TO BE SURE THEY ARE TIGHT
- IF PARTS ARE MISSING, BROKEN, DAMAGED OR WORN, STOP USE OF THIS PRODUCT UNTIL REPAIRS ARE MADE, USING FACTORY AUTHORISED PARTS
- FAILURE TO FOLLOW THESE WARNINGS COULD RESULT IN SERIOUS INJURY

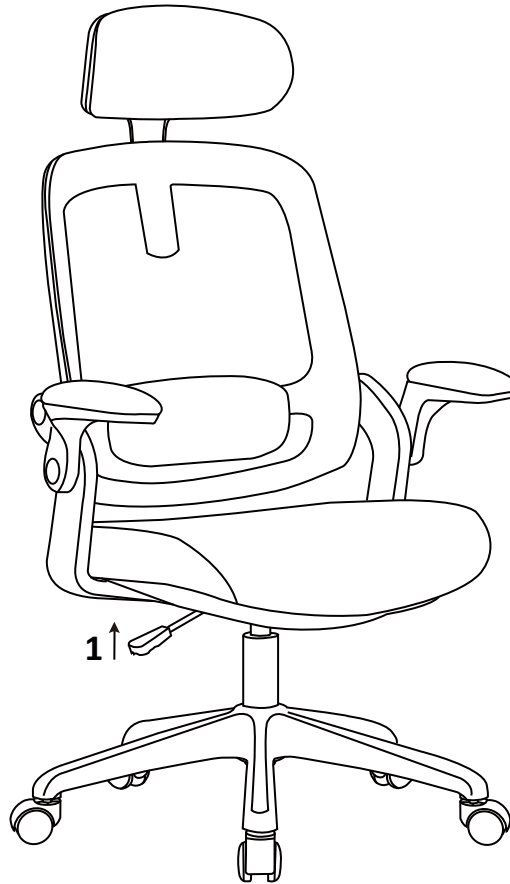
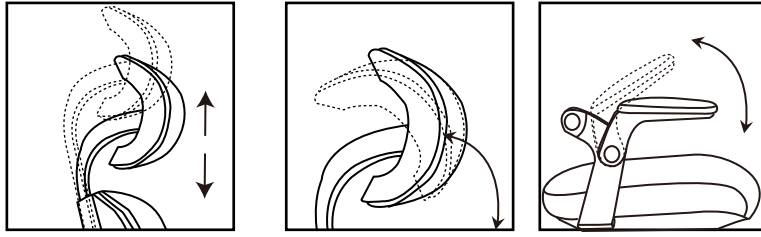

1

